

ENGLISH USER GUIDE

Bluetooth innoXplore HiFi Receiver

OdiO R1

General:

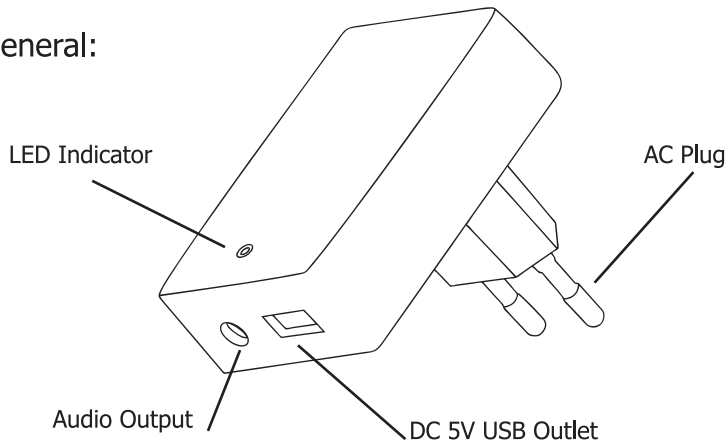

The innoXplore OdiO R1 is a HiFi Stereo Receiver using Bluetooth wireless technology, it provides a wireless radio scope of range at maximum 10 M in an open space without barrier.

As a Bluetooth HiFi Receiver (Rx), the OdiO R1 can simply connect to the LINE-IN or AUX-IN port of the HiFi stereo system, you can then stream stereo music from your iPhone/smart phone or other Bluetooth A2DP enabled digital music player to the HiFi stereo or car stereo system, enjoy the high quality music and the convenience of having your music source in the palm of your hands.

The innoXplore OdiO R1 is built with latest apt-X and AAC audio codec, which means that it delivers full 'wired' audio quality. With the aptX audio codec source material is transparently delivered over the Bluetooth link, whether it is stored uncompressed or in an alternative compression (MP3, AAC, FLAC) format.

The package contains:

- 1 x innoXplore OdiO R1 HiFi Receiver
- 1 x 120cm 3.5mm to 3.5mm audio cable
- 1 x 20 cm 3.5mm to 2RCA Converter
- 1 X QSG

Assembly:

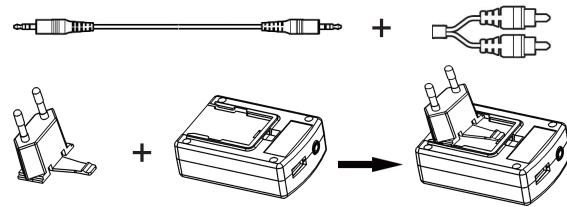

Before you can use innoXplore OdiO R1, your iPhone or other Bluetooth devices must support the Bluetooth Advanced Audio Distribution Profile (A2DP).

Setup:

1. Slide the power plug onto the unit.
2. Connect the audio cable in between the innoXplore OdiO R1 and HiFi stereo system.
3. Plug the OdiO R1 into a power outlet. The blue light on the OdiO R1 will blink quickly and step into pairing mode.
4. Pair your iPhone to the OdiO R1. Follow your iPhone's users guide on how to search and add a Bluetooth device. Generic instructions from your iPhone:
 - a. Turn the Bluetooth functionality ON.
 - b. Make the device visible
 - c. When the "OdiO R1" appears on your iPhone pair with the password "0000" or it will proceed pairing automatically.
5. The iPhone is paired and connected with the OdiO R1 when the LED Blinking twice per half second, when the music is on playing then LED light will be turned into constant light. The LED blue light is blinking twice per second when Bluetooth is disconnected.
6. the OdiO R1 will autoconnect to the pair phone per each power on of the OdiO R1.
7. the Bluetooth will disconnect if the paired working devices are out of range, the OdiO R1 will auto reconnect when the paired device return back to the range within seconds.

Operating Instructions:

You would only need to "Pair" the iPhone to the OdiO R1 once, after that you just need to "connect" iPhone to IT. You can "Pair" other devices to OdiO R1 but you can only "connect" one device at a time.

